

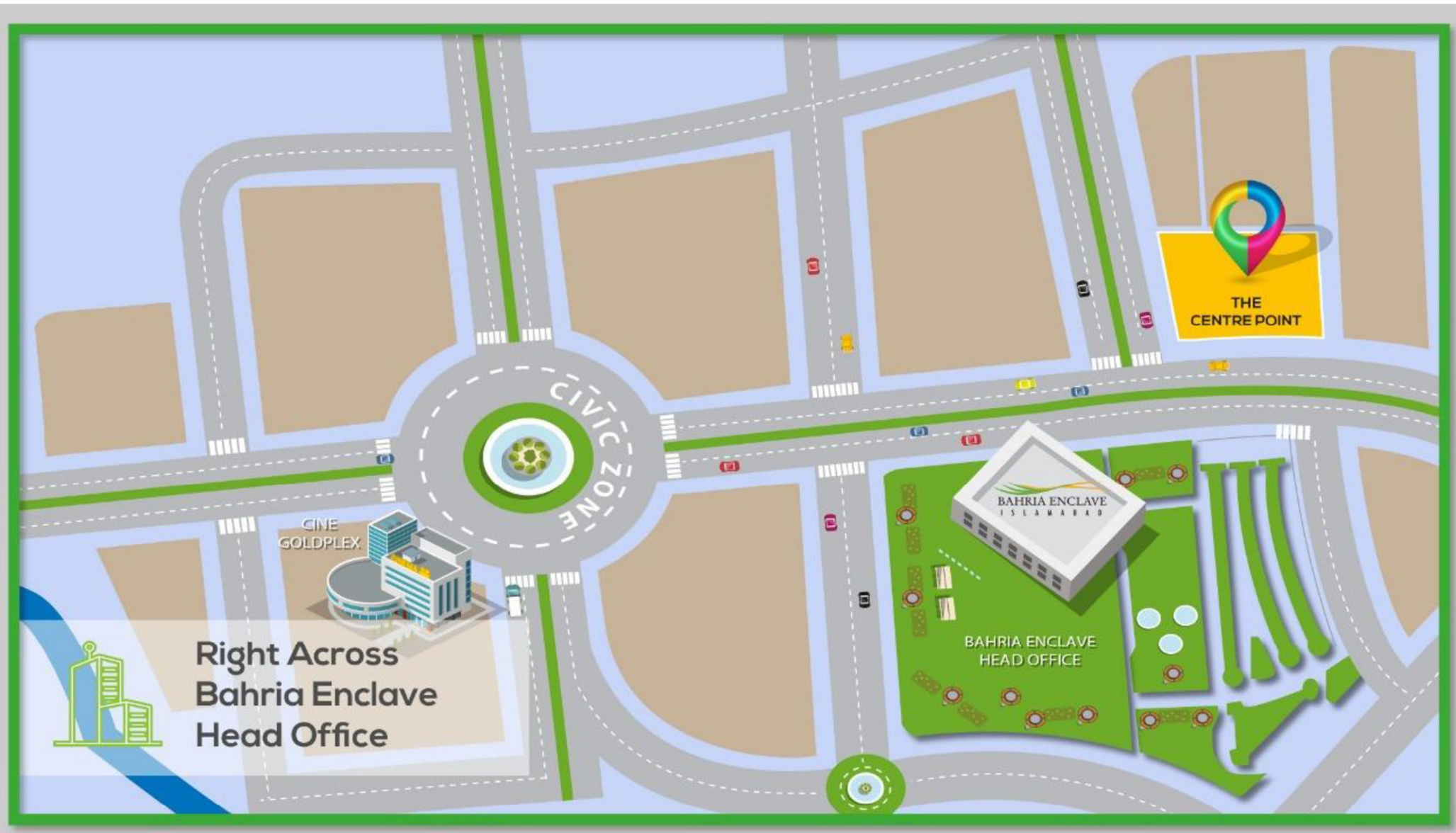

THE CENTRE POINT RESIDENCE





**Right Across
Bahria Enclave
Head Office**





THE CENTRE POINT
R E S I D E N C E

- **In the Heart of the Civic Zone, Bahria Enclave Islamabad**
- **Iconic Landmark - Right Across Bahria Enclave Head Office**
- **Based on 13 Kanals (200 x 300 Sq Ft Approx)**
- **G+8 (Ground + 8 Floors - 116 Ft Tall)**
- **Walking Distance from Cine Goldplex Cinema**
- **Completion Date Sep 2023**



Panoramic View of
Margalla & Muree Hills

A modern kitchen with dark cabinetry, a woman at the sink, and a large refrigerator. The kitchen features dark grey or black cabinetry with a white countertop. A woman in a black and white patterned shirt and blue jeans is standing at the sink, which has a modern faucet. To the right, there is a large refrigerator with a digital display on the door. The backsplash is made of small, dark, patterned tiles. A white ceiling fan is visible above the kitchen. The floor is light-colored. The entire image is framed with a green border.

**Modern, Elegant &
Spacious Kitchens**



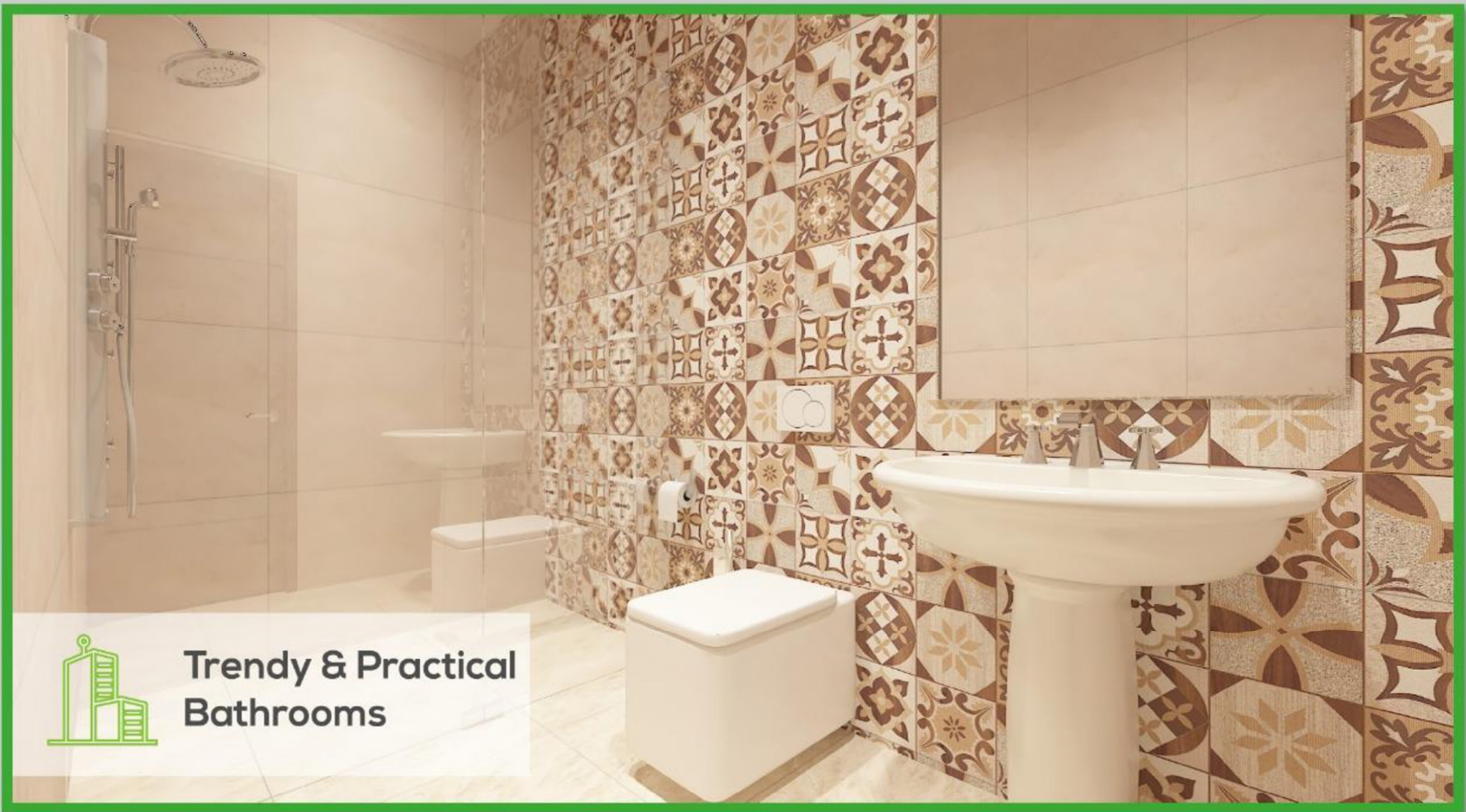

**Trendy & Practical
Bathrooms**

THREE BEDROOM LUXURY

Covered Area: 2425 Sq. ft.

 THE CENTRE POINT
RESIDENCE

- 1 Bed Room (1) 13 x 10.4
- 2 Bath (1) 8' x 5'
- 3 Bed Room (2) 12' X13'
- 4 Bath (2) 5' x 9'
- 5 Bed Room (3) 12' X13'
- 6 Bath (3) 9' x 4'
- 7 Lounge 12' x 14'
- 8 Bath 8' x 4'
- 9 Dining 13x8
- 10 Store 5x 5
- 11 Balcony 12 x 5
- 12 kitchen 12' x7'
- 13 Servent Q 7 x 6
- 14 S Bath 4x 6
- 15 Service balcony 5 x 6

Experience luxurious living with breathtaking views of Murree and Margalla hills. These beautifully designed modern apartment incorporate sweeping aesthetics with premium amenities.

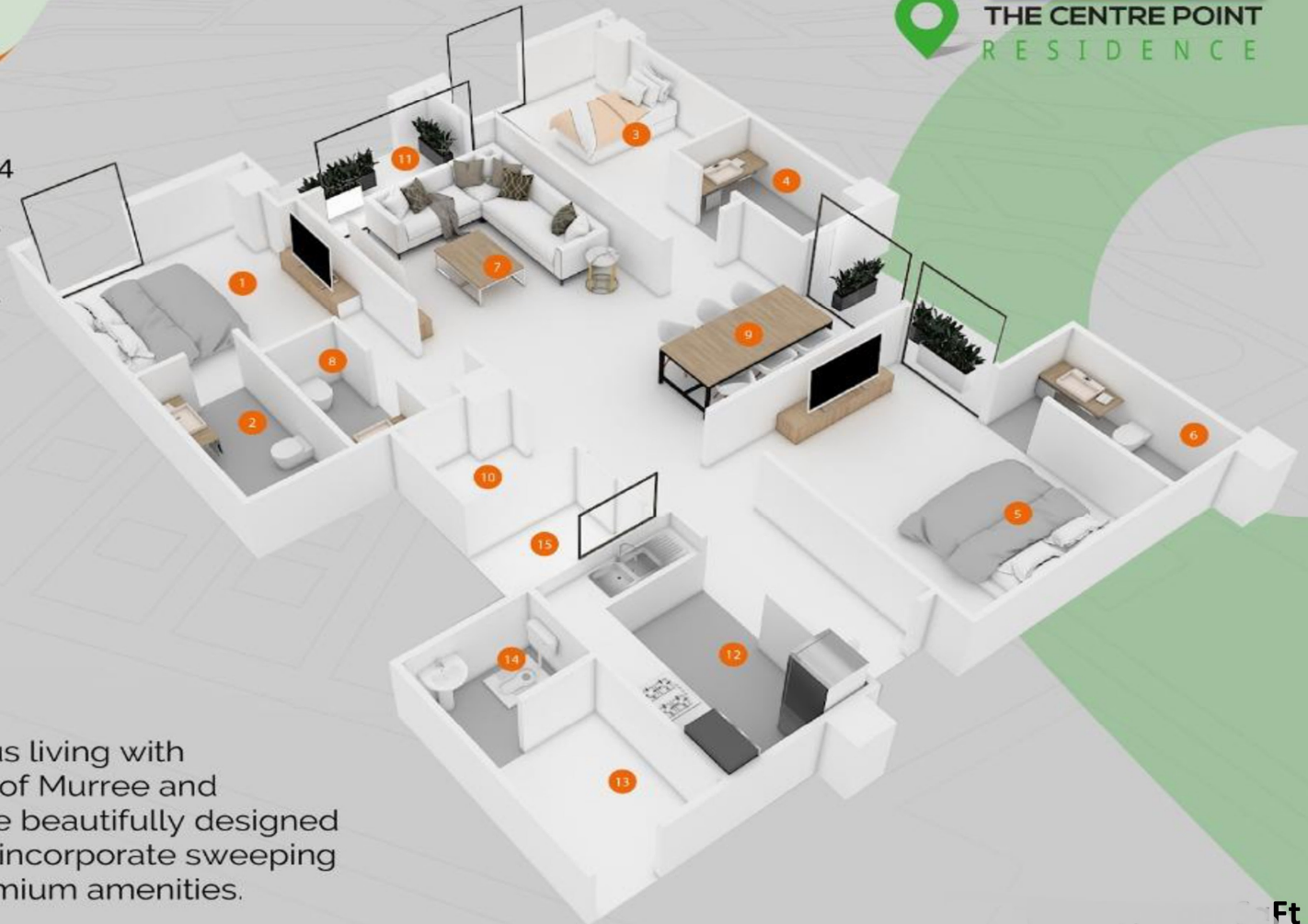

2425 Sq Ft

THREE BEDROOM
LUXURY

Covered Area: 2425 Sq. ft.

 **THE CENTRE POINT**
RESIDENCE



THREE BEDROOM LUXURY

Covered Area: 2425 Sq. ft.

 THE CENTRE POINT
RESIDENCE



THREE BEDROOM
LUXURY

Covered Area: 2425 Sq. ft.



THE CENTRE POINT
RESIDENCE



THREE BEDROOM
LUXURY

Covered Area: 2425 Sq. ft.



THE CENTRE POINT
RESIDENCE



THREE BEDROOM ELEGANT

Covered Area: 1950 Sq. ft.



- 1 Bed Room (1) 12' X13'
- 2 Bed Room (2) 10' X12'
- 3 Bed Room (3) 13' X12'
- 4 Bath (1) 8' x 4'
- 5 Bath (2) 5' x 9'
- 6 Bath (3) 5' x 7'
- 7 Lounge 22' x 12'
- 8 kitchen 12' x 8'
- 9 Balcony 7' x 6'
- 10 Store 7' x 5'
- 11 Servent Q 7' x 6'
- 12 Servent Bath 6' x 4'
- 13 Balcony 12' x 4'
- 14 Service balcony 6' x 6'

Your new home is waiting for you to take the elevator ride up to the 8th floor, take in the view, and never want to leave. Our community creates a fun and inviting atmosphere with common spaces.



THREE BEDROOM ELEGANT

Covered Area: 1950 Sq. ft.



THE CENTRE POINT
RESIDENCE



THREE BEDROOM ELEGANT

Covered Area: 1950 Sq. ft.



THE CENTRE POINT
RESIDENCE



THREE BEDROOM
ELEGANT

Covered Area: 1950 Sq. ft.



THE CENTRE POINT
RESIDENCE



THREE BEDROOM
ELEGANT

Covered Area: 1950 Sq. ft.



THE CENTRE POINT
RESIDENCE



THREE BEDROOM ECONOMY

Covered Area: 1650 Sq. ft.

 THE CENTRE POINT
RESIDENCE

- 1 Bed Room (1) 12' X13'
- 2 Bed Room (2) 12' X13'
- 3 Bed Room (3) 12' X13'
- 4 Bath (1) 6' x 7'
- 5 Bath (2) 6' x 7'
- 6 Bath (3) 6' x 7'
- 7 Lounge 12 x 13
- 8 kitchen 8' x 9'
- 9 Store 8 x 4
- 10 Balcony 6 x 9

Designed for budget-friendly luxury living, this apartment is outfitted with premium amenities including a built-in air conditioning facility, fully equipped kitchen, spacious balconies and glass windows.



1650 Sq. Ft

THREE BEDROOM ECONOMY

Covered Area: 1650 Sq. ft.

 THE CENTRE POINT
RESIDENCE



THREE BEDROOM ECONOMY

Covered Area: 1650 Sq. ft.

 THE CENTRE POINT
RESIDENCE



THREE BEDROOM ECONOMY

Covered Area: 1650 Sq. ft.



THE CENTRE POINT
RESIDENCE



THREE BEDROOM
ECONOMY

Covered Area: 1650 Sq. ft.

 **THE CENTRE POINT**
RESIDENCE



TWO BEDROOM ECONOMY

Covered Area: 1265 Sq. ft.

 THE CENTRE POINT
RESIDENCE

- 1 Bed Room (1) 12' X13'
- 2 Bath (1) 6' x 7'
- 3 Bed Room (2) 12' X13'
- 4 Bath (2) 6' x 7'
- 5 Lounge (3)12' x 13'
- 6 Store (4) 8 x 4
- 7 Kitchen (5) 8' x 9'

Thoughtfully designed with space to thrive, these economy apartments are the perfect place for your new home. Large bedrooms, common area and an open kitchen give you a close family living environment.

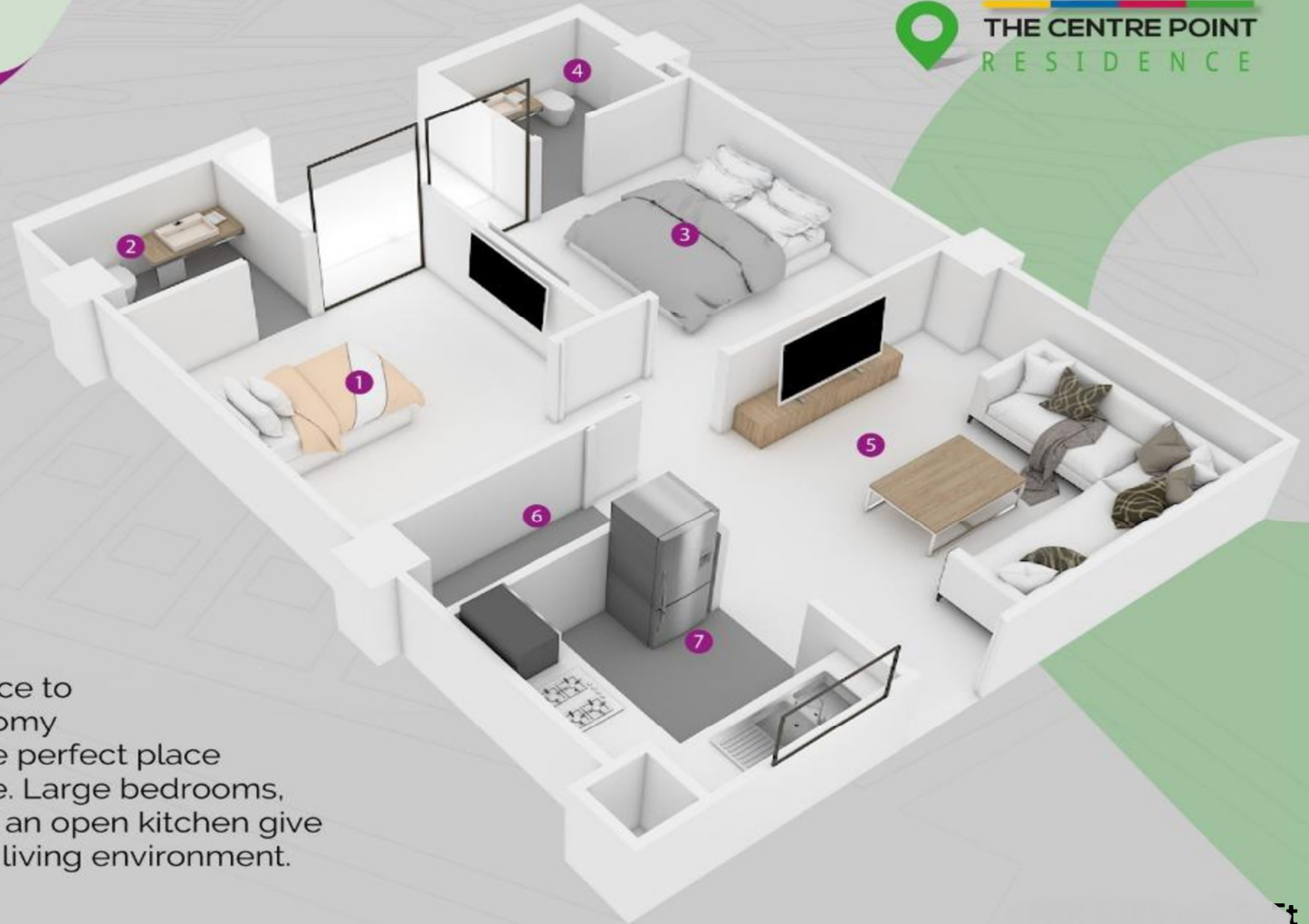

TWO BEDROOM ECONOMY

Covered Area: 1265 Sq. ft.

 THE CENTRE POINT
RESIDENCE



TWO BEDROOM ECONOMY

Covered Area: 1265 Sq. ft.

 THE CENTRE POINT
RESIDENCE



TWO BEDROOM ECONOMY

Covered Area: 1265 Sq. ft.



THE CENTRE POINT
RESIDENCE

TWO BEDROOM
ECONOMY

Covered Area: 1265 Sq. ft.

 **THE CENTRE POINT**
RESIDENCE



ONE BEDROOM UNIQUE

Covered Area: 1085 Sq. ft.

 THE CENTRE POINT
RESIDENCE

- 1 Bed Room 13' X12'
- 2 Bath 9' x 5'
- 3 Lounge 17' x 10'
- 4 Kitchen 12' x10'
- 5 Balcony 4' x 12'

An excellent startup home for a small and joyful family, centrally located in Civic Zone at a walking distance to Shopping Malls, Cinema and other amenities. Every apartment is a corner apartment with easy access to elevators and stairs.



ONE BEDROOM
UNIQUE

Covered Area: 1085 Sq. ft.



THE CENTRE POINT
RESIDENCE



ONE BEDROOM
UNIQUE

Covered Area: 1085 Sq. ft.



THE CENTRE POINT
RESIDENCE



ONE BEDROOM
UNIQUE

Covered Area: 1085 Sq. ft.

 THE CENTRE POINT
RESIDENCE



ONE BEDROOM
UNIQUE

Covered Area: 1085 Sq. ft.

 **THE CENTRE POINT**
RESIDENCY







It's all about Location!

www.TheCentrePoint.pk

For Booking & details, please call +92 3111 786 738